

EDRG-T Galvanised steel circular shut-off dampers

Description

Galvanised steel circular dampers with silicone sealing gasket on the blade.

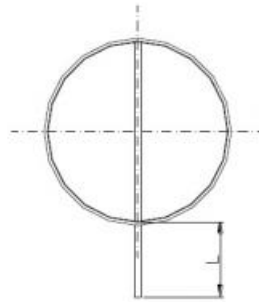
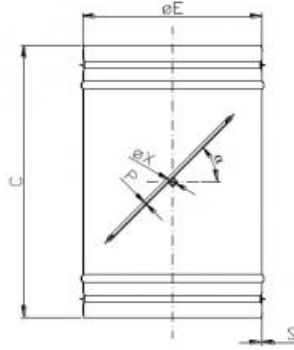

Use

Shut-off dampers are used in ventilation and air conditioning systems to balance the circuits.

Characteristics

Galvanised steel frame (for thickness and length, see illustrative table), galvanised steel sheet blade (for thickness, see illustrative table), control pins $\varnothing 8$ mm or $\varnothing 12$ mm (see illustrative table), bronze bushings if $\varnothing 8$ and nylon bushings if $\varnothing 12$, silicone gasket on the blade.

Self-generated noise tests performed according to the EN ISO 3741 Standard. Tightness test according to the EN 1751 Standard.

On request

AISI 304-316L version;

Version with bronze bushings and thermally insulated support for high temperature up to 180°C.

Accessories

Flange;

Manual control R9 for pin $\varnothing 8$ mm;

Manual control R11/R12 for pin $\varnothing 12$ mm;

Belimo electric servomotor.

EDRG-T price list and dimensions

Item normally available from stock

EDRG-T MODEL	S Galvanised steel sheet thickness	\varnothing pin mm	C frame depth mm	L pin protrusion mm	€
100	8/10	8	200	60	52,32
125	8/10	8	200	60	56,98
150	8/10	8	200	60	62,22
160	8/10	8	200	60	64,72
180	8/10	8	200	60	69,95
200	8/10	8	200	60	75,21
250	8/10	8	200	60	81,69
280	8/10	8	200	60	a.r.
300	10/10	12	300	100	91,89
315	10/10	12	300	100	101,33
355	10/10	12	300	100	131,36
400	12/10	12	400	100	164,21

Thermally insulated support

Description	€
Thermally insulated support for GALVANISED steel sheet EDRG-T	267,47
Thermally insulated support for 304 STAINLESS steel EDRG-T	a.r.
Thermally insulated support for 316L STAINLESS steel EDRG-T	a.r.

Manual control

\varnothing pin (mm)	Description	€
8	Manual control R9 for EDRG-T	9,45
12	Manual control R11 for EDRG-T	26,45
12	Manual control R12 for EDRG-T	37,79

R 9



R 11

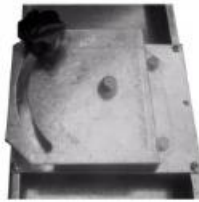

R 12

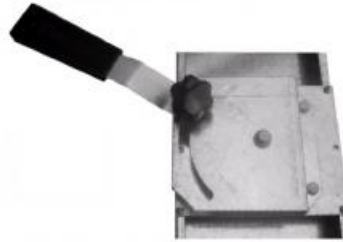

Recommended servomotors

		Servomotor WITHOUT SPRING RETURN
Torque		LM..A
Universal clamp for pin size (mm):		5 Nm
For dampers up to:		6-20
		1 m ²
ON/OFF 3-Point	AC /DC 24 V	LM24A
	AC /DC 24 V With auxiliary contact	LM24A-S
	AC 230 V	LM230A
	AC 230 V With auxiliary contact	LM230A-S
MODULATING 0...10V command	AC /DC 24 V	LM24A-SR
	AC /DC 24 V With auxiliary contact	
	AC 230 V	LM230ASR

		Servomotors WITH SPRING RETURN up to model EDRG-T 280	Servomotors WITH SPRING RETURN from model EDRG-T 300 to model EDRG-T 400
Torque		LF	NF
Universal clamp for pin size (mm):		4 Nm	10 Nm
For dampers up to:		8-16	10-22
		0,8 m ²	2 m ²
ON/OFF 3-Point	AC /DC 24 V	LF24	NF24A
	AC /DC 24 V With auxiliary contact	LF24-S	NF24A-S2
	AC 230 V	LF230	NFA
	AC 230 V With auxiliary contact	LF230-S	NFA-S2
MODULATING 0...10V command	AC /DC 24 V	LF24-SR	NF24A-SR
	AC /DC 24 V With auxiliary contact		NF24A-SR-S2
	AC 230 V		