

EDRC - EDRCS - EDRC-PQR - EDRCS-PQR Variable geometry diffusers



Description

Variable geometry diffusers with adjustable deflector blades and equaliser.

Characteristics

Material: aluminium structure with steel blades
Finish: painted white RAL 9010.

Use

Diffusers suitable for heating and cooling large rooms requiring a high installation height and in any case not less than 3.5 metres.

For both duct and ceiling installation.

Models

- EDRC: diffusers with individually adjustable blades and equaliser;
- EDRCS: diffusers with simultaneously adjustable blades and equaliser;
- EDRC-PQR: diffusers with individually adjustable blades on square panel 597x597 mm and fitting with equaliser
- EDRCS-PQR: diffusers with simultaneously adjustable blades on square panel 597x597 mm and fitting with equaliser.

Accessories

Fin adjustment via motorised control.

On request

The diffuser is supplied with factory pre-set fin inclination adjustment or with a servo control for fin adjustment.

EDRC-PQR and EDRCS-PQR diffusers can be supplied without fitting and equaliser, but the possibility of installing them is not guaranteed.

Dimensions

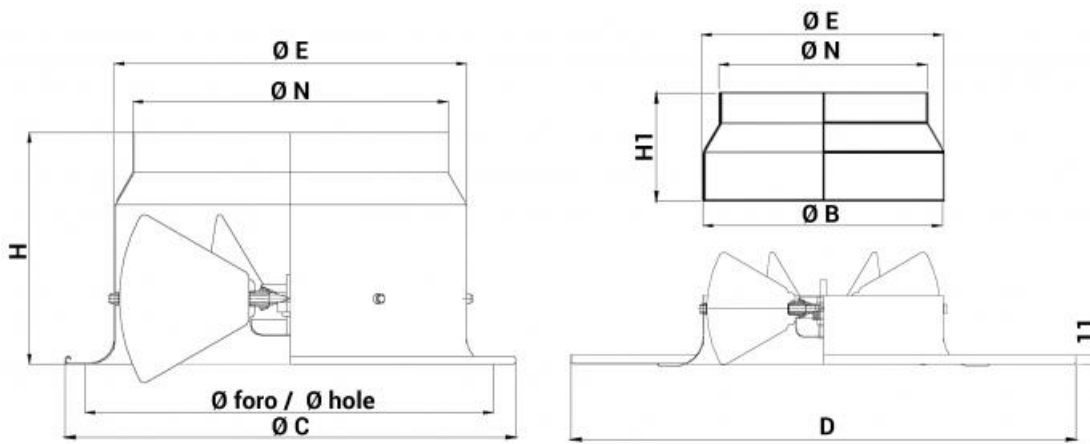

all dimensions are expressed in mm

| model | effective cross-section m ² | EDRC - EDRCS | | | | | EDRC-PQR - EDRCS-PQR | | | | |
|-------|---|--------------|-----|-----|--------|-----|----------------------|---------|-----|-----|-----|
| | | Ø N | Ø C | Ø E | Ø hole | H | Ø N | D | Ø E | Ø B | H1 |
| 250 | 0,0569 | 248 | 393 | 283 | 340 | 205 | 248 | 597x597 | 283 | 286 | 145 |
| 315 | 0,0902 | 313 | 458 | 348 | 400 | 230 | 313 | 597x597 | 348 | 352 | 145 |
| 400 | 0,1243 | 398 | 563 | 437 | 500 | 270 | 398 | 597x597 | 437 | 436 | 200 |
| 500 | 0,1947 | 498 | 683 | 540 | 630 | 320 | - | - | - | - | - |
| 630 | 0,3095 | 628 | 803 | 675 | 760 | 390 | - | - | - | - | - |

Operating data in heating mode with blade angle at 35°

Data referring to a terminal velocity Vt=0.25 m/s and with a temperature differential of 10 and 15°C

Vk: effective speed (m/s)

m³/h: air flow rate

Pa: pressure drops in Pascal

L(m): air throw in metres

dB(A): noise level

| Model | | EDRC - EDRCS - EDRC-PQR - EDRCS-PQR Heating 35° | | | | | | | | | | | |
|-----------|-----|---|-------------------|------|-----|------|-----|------|------|------|------|------|-----|
| | | m ³ /h | 410 | | 630 | | 850 | | 1000 | | 1300 | | |
| EDRC | 250 | Δt (°C) | 10 | 15 | 10 | 15 | 10 | 15 | 10 | 15 | 10 | 15 | |
| | | Vk (m/s) | 2 | | 3,1 | | 4,1 | | 4,9 | | 6,3 | | |
| EDRCS | | L(m) | 2,2 | 1,8 | 3,1 | 2,5 | 4 | 3,3 | 4,6 | 3,7 | 5,7 | 4,7 | |
| EDRC-PQR | | | Pa | 5 | | 12 | | 22 | | 30 | | 51 | |
| EDRCS-PQR | | dB(A) | 37 | | 49 | | 58 | | 63 | | 70 | | |
| EDRC | | 315 | m ³ /h | 650 | | 1000 | | 1350 | | 1590 | | 2060 | |
| | | | Δt (°C) | 10 | 15 | 10 | 15 | 10 | 15 | 10 | 15 | 10 | 15 |
| EDRCS | | | Vk (m/s) | 2 | | 3,1 | | 4,2 | | 4,9 | | 6,3 | |
| EDRC-PQR | | | L(m) | 2,6 | 2,1 | 4,1 | 3,3 | 5,5 | 4,5 | 6,4 | 5,3 | 8,3 | 6,8 |
| EDRCS-PQR | | | Pa | 5 | | 12 | | 22 | | 31 | | 52 | |
| dB(A) | 39 | | 51 | | 60 | | 65 | | 72 | | | | |
| EDRC | 400 | | m ³ /h | 1040 | | 1600 | | 2160 | | 2540 | | 3290 | |
| | | | Δt (°C) | 10 | 15 | 10 | 15 | 10 | 15 | 10 | 15 | 10 | 15 |
| EDRCS | | | Vk (m/s) | 2,3 | | 3,6 | | 4,8 | | 5,7 | | 7,4 | |
| EDRC-PQR | | | L(m) | 2,8 | 2,3 | 4,3 | 3,5 | 5,9 | 4,8 | 6,9 | 5,7 | 8,9 | 7,3 |
| EDRCS-PQR | | Pa | 5 | | 12 | | 22 | | 31 | | 52 | | |
| dB(A) | | 41 | | 54 | | 63 | | 67 | | 75 | | | |
| EDRC | | 500 | m ³ /h | 1640 | | 2530 | | 3425 | | 4020 | | 5210 | |
| | | | Δt (°C) | 10 | 15 | 10 | 15 | 10 | 15 | 10 | 15 | 10 | 15 |
| EDRCS | | | Vk (m/s) | 2,3 | | 3,6 | | 4,9 | | 5,7 | | 7,4 | |
| L(m) | | | 3,2 | 2,6 | 5,1 | 4,1 | 6,9 | 5,6 | 8,2 | 6,7 | 10,7 | 8,7 | |
| Pa | 5 | | 12 | | 22 | | 31 | | 52 | | | | |
| dB(A) | 42 | | 55 | | 64 | | 68 | | 76 | | | | |
| EDRC | 630 | | m ³ /h | 2570 | | 3970 | | 5370 | | 6300 | | 8170 | |
| | | | Δt (°C) | 10 | 15 | 10 | 15 | 10 | 15 | 10 | 15 | 10 | 15 |
| EDRCS | | | Vk (m/s) | 2,3 | | 3,6 | | 4,8 | | 5,7 | | 7,3 | |
| L(m) | | | 3,4 | 2,8 | 5,3 | 4,3 | 7,2 | 5,9 | 8,5 | 6,9 | 11 | 9 | |
| Pa | | 5 | | 12 | | 22 | | 31 | | 52 | | | |
| dB(A) | | 42 | | 55 | | 64 | | 69 | | 76 | | | |

Operating data in cooling mode with blade angle at 46°

Data referring to a terminal velocity Vt = 0.25 m/s and with a temperature differential of 10 and 15°C

| Model | | EDRC - EDRCS - EDRC-PQR - EDRCS-PQR Cooling 46° | | | | | | | | | | | |
|-----------|-----|---|-------------------|------|-----|------|------|------|------|------|------|------|-----|
| | | m ³ /h | 410 | | 630 | | 850 | | 1000 | | 1300 | | |
| EDRC | 250 | Δt (°C) | 10 | 15 | 10 | 15 | 10 | 15 | 10 | 15 | 10 | 15 | |
| | | Vk (m/s) | 2 | | 3,1 | | 4,1 | | 4,9 | | 6,3 | | |
| EDRCS | | L(m) | 2,4 | 2,9 | 3,8 | 4,5 | 5,2 | 6 | 6,2 | 7,3 | 8,1 | 9,6 | |
| EDRC-PQR | | | Pa | 14 | | 32 | | 58 | | 81 | | 137 | |
| EDRCS-PQR | | dB(A) | 39 | | 51 | | 60 | | 65 | | 72 | | |
| EDRC | | 315 | m ³ /h | 650 | | 1000 | | 1350 | | 1590 | | 2060 | |
| | | | Δt (°C) | 10 | 15 | 10 | 15 | 10 | 15 | 10 | 15 | 10 | 15 |
| EDRCS | | | Vk (m/s) | 2 | | 3,1 | | 4,2 | | 4,9 | | 6,3 | |
| EDRC-PQR | | | L(m) | 2,4 | 2,8 | 3,8 | 4,4 | 5,2 | 6,1 | 6,2 | 7,2 | 8,1 | 9,5 |
| EDRCS-PQR | | | Pa | 15 | | 36 | | 66 | | 91 | | 153 | |
| dB(A) | 41 | | 53 | | 62 | | 67 | | 74 | | | | |
| EDRC | 400 | | m ³ /h | 1040 | | 1600 | | 2160 | | 2540 | | 3290 | |
| | | | Δt (°C) | 10 | 15 | 10 | 15 | 10 | 15 | 10 | 15 | 10 | 15 |
| EDRCS | | | Vk (m/s) | 2,3 | | 3,6 | | 4,8 | | 5,7 | | 7,4 | |
| EDRC-PQR | | | L(m) | 2,3 | 2,7 | 3,6 | 4,2 | 4,9 | 5,8 | 5,8 | 6,9 | 7,6 | 8,9 |
| EDRCS-PQR | | Pa | 16 | | 37 | | 67 | | 93 | | 157 | | |
| dB(A) | | 43 | | 56 | | 65 | | 69 | | 76 | | | |
| EDRC | | 500 | m ³ /h | 1640 | | 2530 | | 3425 | | 4020 | | 5210 | |
| | | | Δt (°C) | 10 | 15 | 10 | 15 | 10 | 15 | - | - | - | - |
| EDRCS | | | Vk (m/s) | 2,3 | | 3,6 | | 4,9 | | 5,7 | | 7,4 | |
| L(m) | | | 5 | 5,8 | 7,9 | 9,2 | 10,8 | 12,7 | - | - | - | - | |
| Pa | 16 | | 38 | | 70 | | 91 | | 113 | | | | |
| dB(A) | 44 | | 57 | | 66 | | 71 | | 78 | | | | |
| EDRC | 630 | | m ³ /h | 2570 | | 3970 | | 5370 | | 6300 | | 8170 | |
| | | | Δt (°C) | 10 | 15 | 10 | 15 | - | - | - | - | - | - |
| EDRCS | | | Vk (m/s) | 2,3 | | 3,6 | | 4,8 | | 5,7 | | 7,3 | |
| L(m) | | | 6,2 | 7,3 | 10 | 11,8 | - | - | - | - | - | - | |
| Pa | | 16 | | 38 | | 70 | | 91 | | 113 | | | |
| dB(A) | | 44 | | 57 | | 66 | | 71 | | 78 | | | |

Price list

| model | EDRC | EDRCS | EDRC-PQR | EDRCS-PQR |
|-------|------|-------|----------|-----------|
| | euro | euro | euro | euro |
| 250 | ✓ | ✓ | ✓ | ✓ |
| 315 | ✓ | ✓ | ✓ | ✓ |
| 400 | ✓ | ✓ | ✓ | ✓ |
| 500 | ✓ | ✓ | - | - |
| 630 | ✓ | ✓ | - | - |