

# ERPC Constant air flow regulators for circular duct



### Description

Flow rate regulators for circular ducts on systems with constant flow rate.  
Automatic mechanical operation, without auxiliary energy to keep the air flow rate constant within a differential pressure range.

### Use

In all ventilation systems to keep the air flow rate constant, regardless of the pressure system used and of the pressure variations within the permissible range.

### Characteristics

Material: galvanised steel.  
Finish: galvanised.  
Operating temperature: -20° +100°C.  
Installation: on circular duct.

### Notes

Air flow rate within a differential pressure range between 40 and 600 Pa (1000 for some models).  
The accuracy of the air flow is ± 5-10%, depending on the speed and conditions of use.  
The regulators can be calibrated on site directly in the finished system by means of the regulating device.  
Maintenance free.

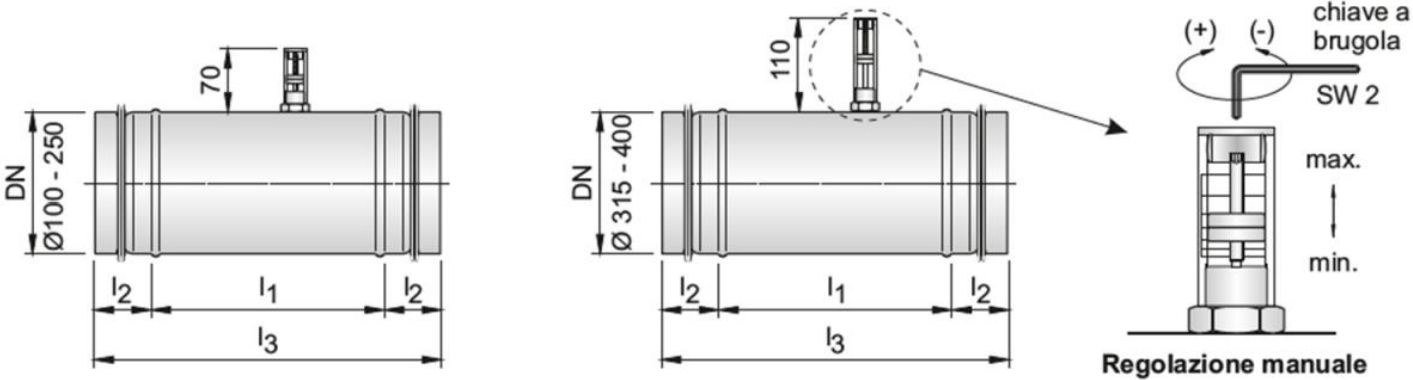

### Operating data and list prices

all dimensions are expressed in mm

Item normally available from stock

diameter DN	Air flow rate (m³/h)		Dimensions (mm)			euro
	min	max	l <sub>1</sub>	l <sub>2</sub>	l <sub>3</sub>	
100	70	220	165	40	245	✓
125	100	280	165	40	245	✓
140	150	400	165	40	245	✓
160	180	500	235	40	315	✓
200	250	900	235	40	315	✓
250	500	1600	235	40	315	✓
315	800	2800	235	60	345	✓
400	1000	4000	295	60	415	✓